

FEATURES & ADVANTAGES

WPio20

Electrical lift and manual lowering

- Sensitive lifting and lowering
- Drive and operating switches with easy reach position
- Automatic braking when the drawbar is released
- Suitable for both left- and right-handed users

Smart Display

- Battery discharge indicator
- Operating hour counter
- Battery management system
- On-board diagnostics via error codes
- Programmability for adapted driving behavior

Smart Key

- Smart-Key activation
- Easy to use
- Access control

Application

- Specially developed for use on level ground
- Powerful 48 Volt drive with Li-ion-Power
- Smooth and quiet operation
- Always usable with the lithium-ion battery from top-up charging
- Quick charging times
- Maneuverability in tight corners
 - Total width (b1) only 645 mm
 - Length to fork face (l2) only 423 mm
 - Turning radius (WA) only 1.428 mm

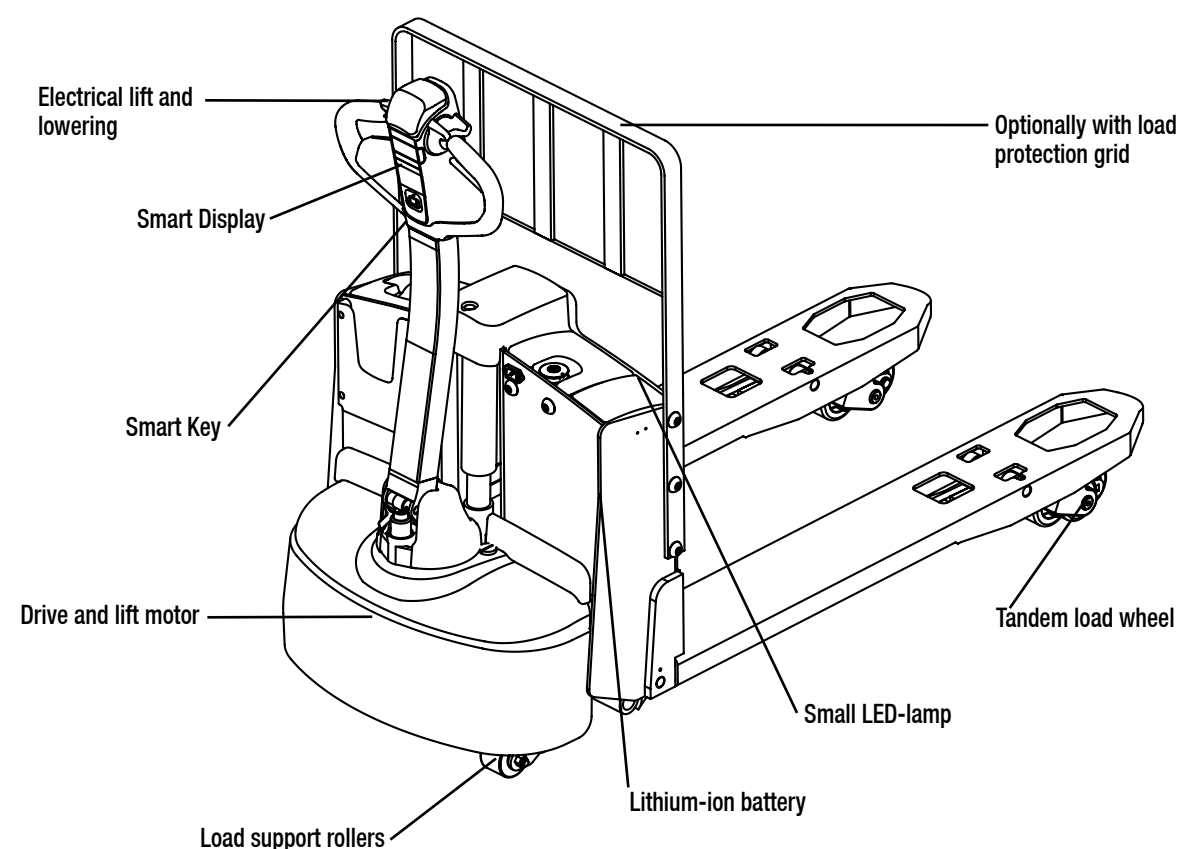

CLARK products, illustrations and specifications are subject to change without notice.
Performance may vary + 5 % and - 10 % due to motor and system efficiency tolerance.

PRODUCT DESCRIPTION



WPio20

The WPio20 – The compact power pack

The WPio20 is an electric low lift pallet truck with a Lithium-ion battery. It is ideal for transporting all kinds of goods over short distances. The minimal L2 dimension (length to face of forks) of only 423 mm, makes the WPio20 extremely compact and ideal for use in confined spaces, e.g. in stores and business centres of all types. A further advantage is the low service weight of only 250 kg.

Thanks to the maintenance-free lithium-ion battery and the included charger daily routines stay much the same when a conventional low lift pallet truck is replaced with the WPio20. The WPio20 is perfect for light duties in goods distribution, production tasks or warehouse applications – an innovative assistant. In addition, a small lamp in the Lithium-ion battery allows lightened dark storage areas.

Advantages of Lithium-ion technology in the WPio20

High performance in a compact design

The high energy density of the installed lithium-ion battery provides great travel performance and long operating periods of up to 5 hours. At the same time, the WPio20 is very compact and has a low service weight, which means it consumes up to 30 % less energy than vehicles with lead-acid batteries.

Fast charging + top-up charging

Top-up charging can be used between full charges without affecting the service life of the battery. The battery can be recharged with any 230-V socket. The Li-ion battery with a weight of only 14 kg can be changed very easily and provides maximum availability. No costs are incurred for adapting the existing charging infrastructure (e.g. ventilation).

Double service life + maintenance-free battery

The Lithium-ion battery has approximately twice the service life of a conventional lead-acid battery. In addition, no maintenance work is required, such as checking the water level around the Lithium-ion battery.

CLARK Europe GmbH Dr.-Alfred-Herrhausen-Allee 33 47228 Duisburg / Germany Tel.: +49 (0)2065 499 13-0 Fax: +49 (0)2065 499 13-290 E-Mail: Info-europe@clarkmheu.com www.clarkmheu.com	Dealer:
--	---------

Nr.: 4582218
Valid for Lot-no.: 8289

01/2020



WPio20

Lithium-Ion Low Lift Pallet Truck
Electrical Lift and Electrical Drive System
2.000 kg

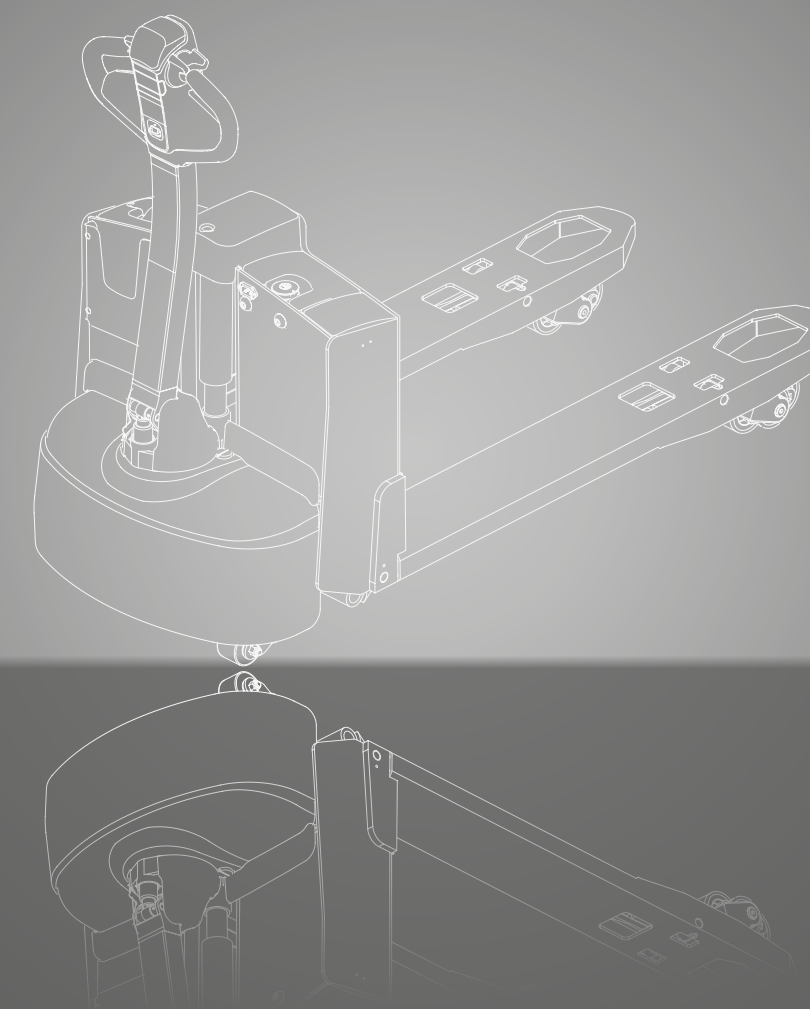

www.clarkmheu.com

DIMENSIONS

WPio20

$$R_h = \sqrt{x^2 + \left(\frac{b_{12}}{2}\right)^2}$$

$$A_{st} = W_a + l_6 - x + a \text{ if } R_h < W_a$$

$$A_{st} = R_h + l_6 - x + a \text{ if } R_h > W_a$$

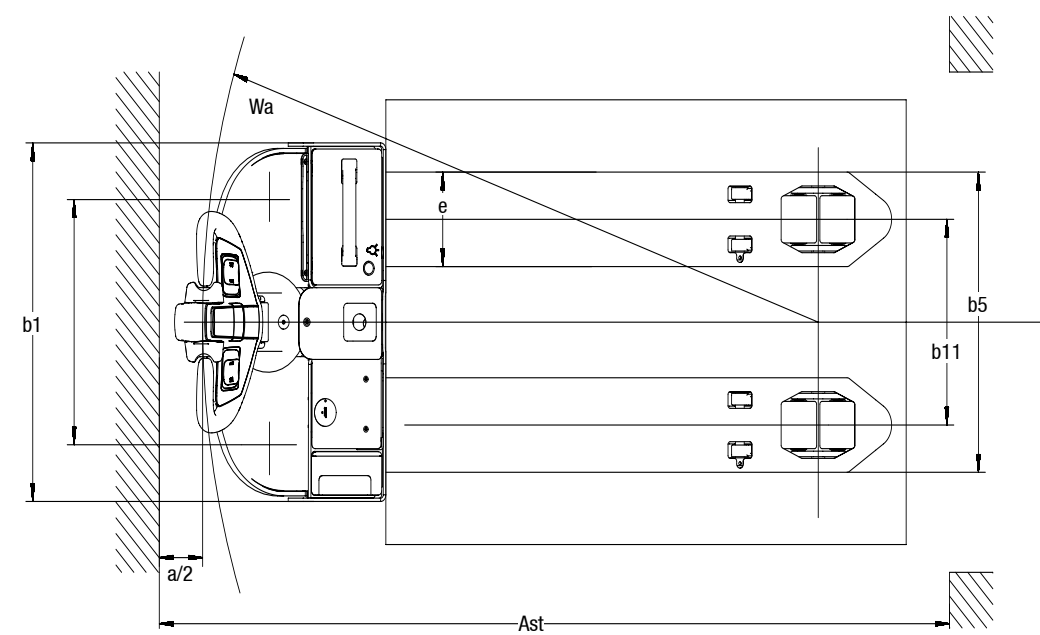
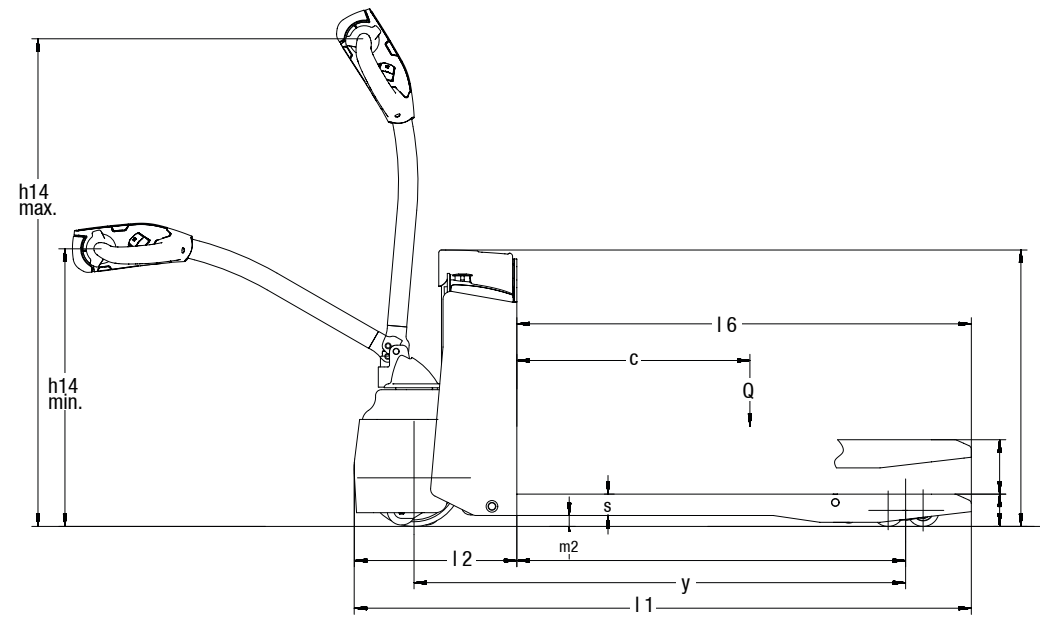

SPECIFICATIONS

Product Specification acc. to VDI 2198

1.1 Manufacturer (Abbreviation)		CLARK
Specifications	1.2 Manufacturer's designation	WPio20
	1.3 Drive	48V Electric
	1.4 Operator type	Pedestrian
	1.5 Rated capacity/rated load	Q (kg) 2000
	1.6 Load centre distance	c (mm) 600
Weight	1.8 Load distance	x (mm) 1000
	1.9 Wheelbase	y (mm) 1268
	2.1 Service weight incl. battery (see 6.5)	kg 250
Weight	2.2 Axle loading, laden front/rear	kg 685 / 1565
	2.3 Axle loading, unladen front/rear	kg 185 / 65
Tyres, Chassis	3.1 Tyres	Polyurethane
	3.2 Tyre size, front	Ø 250 x 102
	3.3 Tyre size, rear	2 x Ø 82 x 85 / Ø 82 x 115
	3.4 Additional wheels (dimensions)	Ø 74 x 48
	3.5 Wheels, number front/rear (x = driven wheels)	1 x + 2 / 4 / 1 x + 2 / 2
	3.6 Tread, front	b10 (mm) 441
	3.7 Tread, rear	b11 (mm) 390 / 450 / 475
Dimensions	4.4 Lift	h3 (mm) 140
	4.4 Lift height	h3 + h13 (mm) 195
	4.9 Height tiller in driving position min./max.	h14 (mm) 716 / 1240
	4.15 Height, lowered	h13 (mm) 82.5
	4.19 Overall length	l1 (mm) 1592
	4.20 Length to face of forks	l2 (mm) 423
	4.21 Overall width	b1 (mm) 645 / 625
	4.22 Fork dimensions	s • e • l (mm) 55 x 170 x 1170
	4.25 Distance between fork-arms	b5 (mm) 540 / 600 / 685
	4.32 Ground clearance, centre of wheelbase	m2 (mm) 27
	4.33 Aisle width for pallets 1000 x 1200 sideways	Ast (mm) 1850
	4.34 Aisle width for pallets 800 x 1200 lengthways	Ast (mm) 2050
4.35 Turning radius	Wa (mm) 1428	
Performance	5.1 Travel speed, laden/unladen	km/h 5.0 / 5.5
	5.2 Lift speed, laden/unladen	m/s 0.023 / 0.029
	5.3 Lowering speed, laden/unladen	m/s 0.037 / 0.027
	5.8 Max. gradeability, laden/unladen *1	% 8 / 16
	5.10 Service brake	Electric
Electrics	6.1 Drive motor rating S2 60 min	kW 0.75
	6.2 Lift motor rating at S3 15 %	kW 0.84
	6.3 Battery acc. to DIN 43531/35/36 A, B, C, no	No
	6.4 Battery voltage/nominal capacity (5hr)	V/Ah 48 / 30
	6.5 Battery weight	kg 14
	6.6 Energy consumption acc. to VDI cycle	kWh/h 0.25
Misc.	- Battery type	Lithium-ion
	8.1 Type of drive unit	DC
Misc.	10.5 Steering design	Mechanical
	10.7 Sound pressure level at the driver's seat acc. to EN 12053	dB(A) 74

*1) At friction coefficient $\mu=0.6$ with 1.6 km/h

EQUIPMENT EXTRAS

		WPio20
General	Easy to handle lithium-ion battery (14 kg)	•
	Truck net weight, including battery 250 kg	•
	Internal charger	•
	External charger	x
	Electrical lift and lowering and electrical drive system	•
Drive Options	Tandem load wheel (polyurethane)	•
	Single load wheel (polyurethane)	x
	Replacement lithium-ion battery	x
	Battery discharge indicator	•
Dimensions	Fork length 850 mm, 1000 mm, 1170 mm, 1220 mm, 1450 mm or 1600 mm	x
	Overall length (l1) 1592 mm	•
	Overall width (b1) 645 / 625 mm	•
Safety	Key switch activation via Smart Key	•
	Monitored by battery management system	•
	Automatic lift stop at maximum lift	•
	Gradient Anti-Roll-Back	•
	Automatic parking brake	•
	Belly switch	•

• = Standard Equipment; x = Option